

Important notice

- 1 If your cat or dog does not run away when you vacuum your home, then they can be trained to like this pet grooming tool. Just turn on vacuum as usual and give enough time for your pet to be familiar with the noise, then you can groom your pet with this tool **connected to vacuum hose**.
- 2 Make sure your pet is fully dry. The pet grooming tool will work with wet hair, but most vacuum cleaners will not, unless it is a wet/dry type. If your vacuum is not a wet/dry type and you use this pet grooming tool on your wet pet, your vacuum motor can possibly be damaged by moisture. The pet grooming tool will work more effectively when your pet is fully dry and you can pull more loose hair off.
- 3 Make sure to comb out all knots on your pet's fur before grooming.
- 4 Do not use this tool on tender skin.
- 5 Never turn comb when it is still deep inside pet's fur. Always activate button after lifting up the pet grooming tool from pet's body,

How to use

- 1 The tool is supplied with comb locked in storage status, to save packing size and for protecting the teeth. Before grooming, just unlock as in **Fig 1**, comb teeth will spring up automatically.
- 2 Connect the tool to your vacuum hose, switch on the vacuum, and lead your pet for grooming when your pet has calmed down.
- 3 Comb your pet as shown in **Fig 2**. After each long stroke or when comb teeth are filled with hair, lift up the tool from pet body, and push activator button with thumb, as in **Fig 3**, hair on comb teeth will go into vacuum automatically. Repeat this action until grooming results are to your satisfaction.
- 4 Once you are finished with the tool, retract comb teeth inside and lock it for protection.

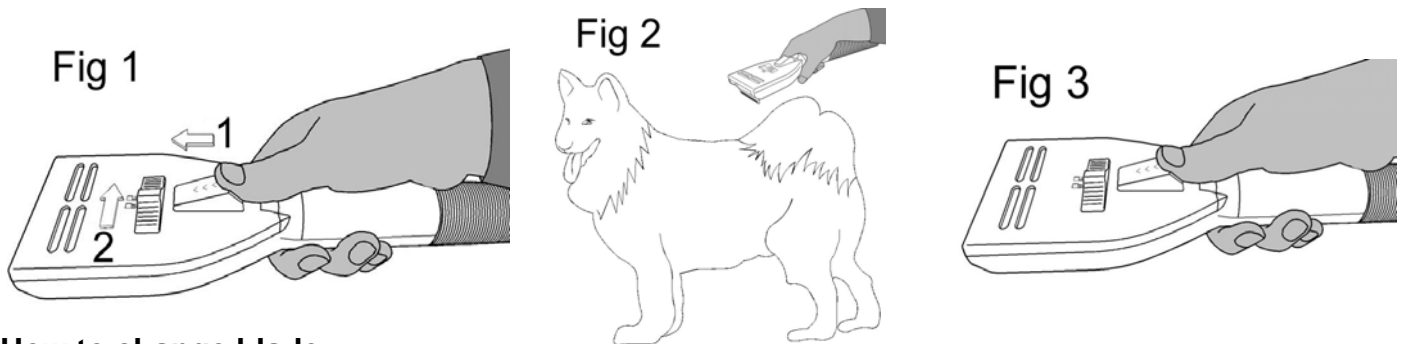

How to change blade

Comb blade can be changed easily. When facing comb teeth as in **Fig 4**, there have spring inside the wall against the right end of comb. Hold comb in the far-left end and push to the right wall, the left comb end will be loosen, then push the left end downward to release it completely, the last stage is to move the left-end closer to your hand to take out the comb, as step 2 of Fig 4.

In order to fit a new comb, just hold the comb by the far-left end (with cut-out), then insert the flat right end against circular recess on the right wall, and push slightly as step 1 shown in **Fig 5**, spring inside circular recess will contract and you will be able to turn the left comb end into place, as step 2 in Fig 5, then let the cut-out fit the rib in the left wall will be ok.

How to use CG-3235

Our tool is design to fit $\phi 32\text{mm}$ vacuum cleaner, which is the most popular in the market. The 2nd popular hose-end is $\phi 35\text{mm}$ type, as shown in **Fig 6** in some Miele vacuum. CG-3235 will adapt $\phi 35\text{mm}$ hose-end to our tool.

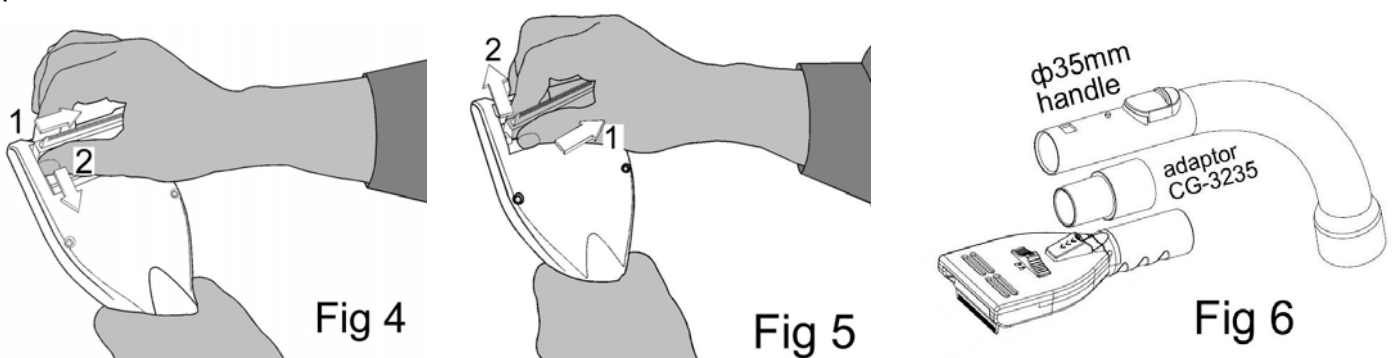

Bridge hose BG-3235 (optional)

In order to get utmost freedom in grooming, we recommend bridge hose BG-3235, as in **Fig 7**. Its stepped larger end can fit both $\phi 32\text{mm}$ and $\phi 35\text{mm}$ vacuum handle, so it can fit most vacuums in the market. Some Zelmer hose can also fit this bridge hose directly.

Bridge hose RG-3235 (optional)

RG-3235 in **Fig 8** is another type bridge hose, with regulatable connector, which can fit vacuum handle from $\phi 32\text{mm}$ to $\phi 35\text{mm}$, and $\phi 38\text{mm}$ with force, so it can fit more regular vacuum cleaners including Hoover, Miele, Electrolux, Siemens, Philips, Panasonic, Bissell etc.

As in Fig 8, insert vacuum handle into RG-3235, hold its larger end with one hand, and turn its thinner end to get tight fix with vacuum handle.

For Zelmer vacuum cleaner (optional)

Some Zelmer vacuum cleaner has higher step around vacuum handle, our oval-shaped adaptor OS-32 can work with it, as in **Fig 9**.

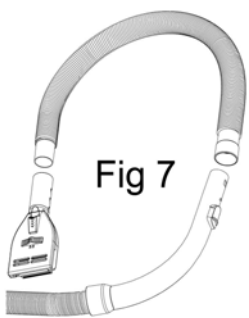

Fig 7

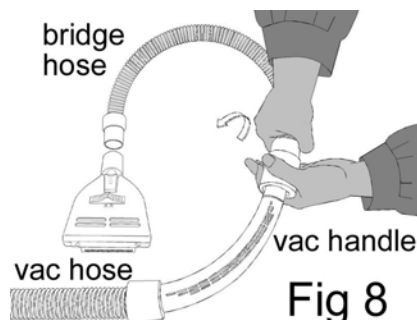

Fig 8

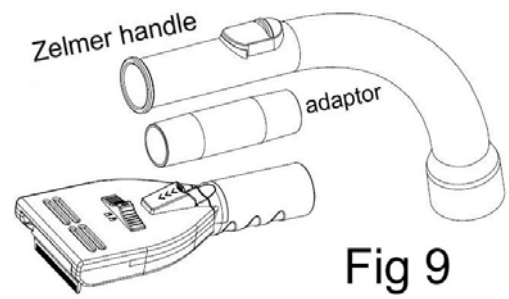

Fig 9

For Dyson and Euro-pro (optional)

Some vacuum cleaners have irregularly shaped vacuum handles, as most Dyson and Euro-pro Shark as in **Fig 10**. Adaptor KT-3242 can fit all these vacuum handles as long as they have a cylindrical internal air channel. As **Fig 11**, insert the rubber end of KT-3242 into the target hose, then hold the middle part of KT-3242 with one hand, and turn the tail of KT-3242 with another hand; the rubber end inside the vacuum handle will spread in all directions like a skirt, so to get a tight fit with the vacuum handle. The tail of KT-3242 can fit grooming tools directly or through a bridge hose.

For flea comb (optional)

Extra flea comb is available for some models. You can take out the original blade comb and install a flea comb as shown above. A flea comb has longer teeth; when turned internally, some loose hair can stay on the root. In order to vacuum it completely, just retract the flea comb as in **Fig 12**, and cover it with a palm; loose hair on the teeth root will be vacuumed away before your hand touches it.

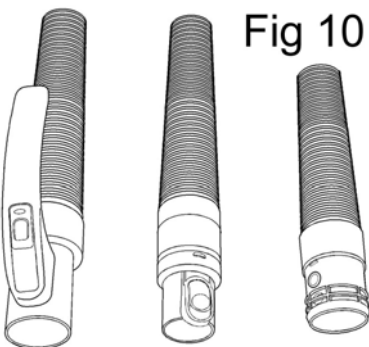

Fig 10

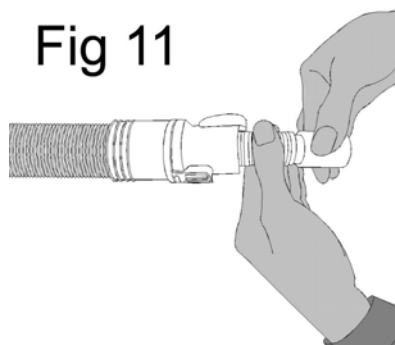

Fig 11

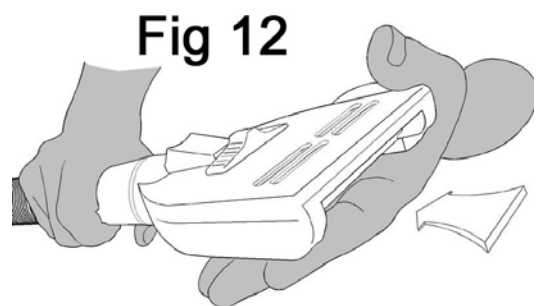

Fig 12